

It is the assembly equipment used in order to connect the temperature sensors to the process. It is used in order that the process does not cease in the sensor replacement, and sensor is not damaged by contacting with the process directly.

It can be manufactured from welded (standard) or full material.

All products are undergone from the hydraulic permeability test. Furthermore, penetration test can be also made optionally. It can be also ordered with material certificate and manufacturer test certificate.

Areas of Applications :

Chemical industry, process technology, with temperature displays...



ELX THERMOVEL

ELX 51 (Threaded Type)

ELX 52 (Flat Type)

ELX 53 (Flanged Type)

ELX 54 (Sanitary Type)

ELX 55 (Dairy Type)

Advantage :

- * Various type material options (316, 316L, 316T, 321, Titanium, Hastelloy etc.)
- * Various connection options
- * Fast delivery
- * Manufacturer test certificate.

Order Form :

Type	Process Connection Size	Sensor Connection Size	Material	Stem Length	Stem Diameter
ELX ...	(R)	(r)		(L)	(d)

Sample :

ELX 51 - 1/2" BSP - 1/2" BSP - 304 St.St.- 150 mm - 13 mm

Dimensions :

Thread Type , ELX 51

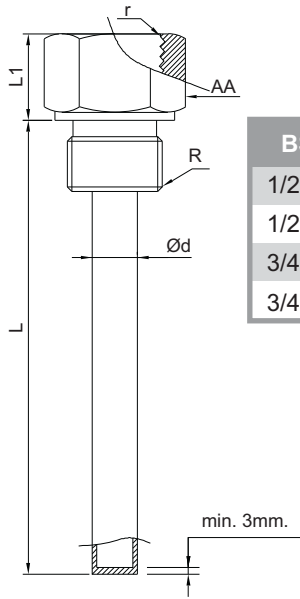

BSP	AA	r	L1
1/2" BSP	24	1/2" BSP	20
1/2" BSP	24	1/4" BSP	20
3/4" BSP	27	1/2" BSP	22
3/4" BSP	36	1/2" BSP	24

Flat Type , ELX 52

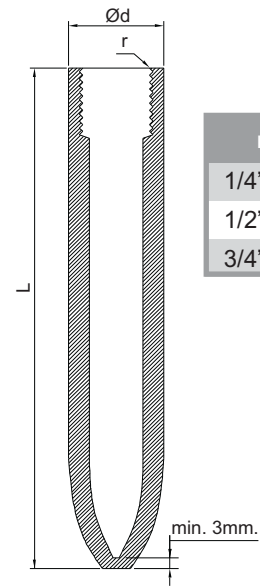

r	Ød
1/4" BSP	18
1/2" BSP	26
3/4" BSP	32

Flanged Type , ELX 53

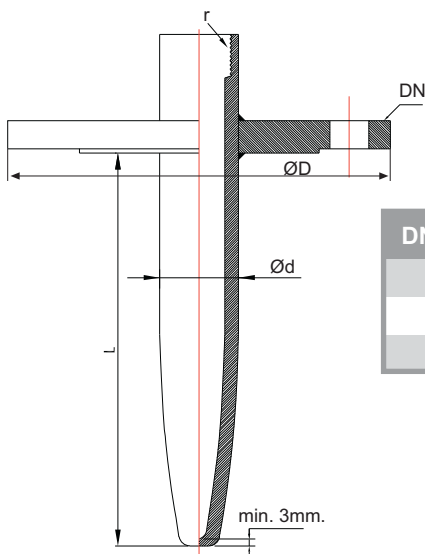

DN (PN16)	Ød	ØD
1"	18	115
2"	26	165
3"	32	200

Sanitary Type , ELX 54

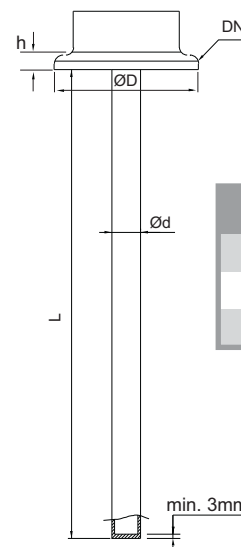

DN	ØD	h
1"	50,4	6,5
1 1/2"	50,4	6,5
2"	63,9	6,5